

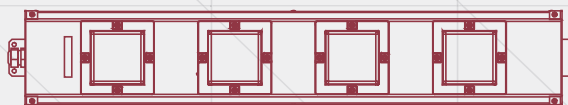

# GEMMA

**GEMMA** luminaire has been design to cover a wide range of lighting needs in potentially explosive atmospheres such as gas or dust. This luminaire can be mounted both suspended and apparent.



# GEMMA

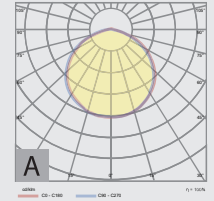

- Installation: Gas station lighting
- Colour temperature: warm, neutral, cold
- Colour rendering index: CRI > 80
- Ingress protection: IP65
- Power supply: 230 V / 50 Hz
- Safety class: II
- Light distribution: A
- Operating temperature range: - 25°C . . . + 45°C

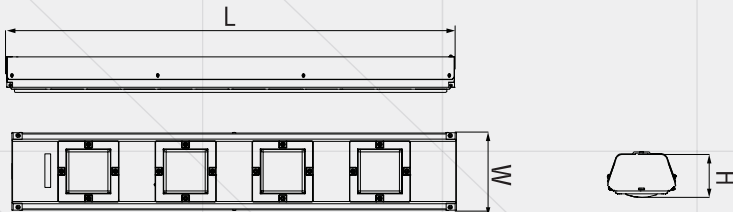

Code	Nominal power	Diffuser	Luminous flux	Dimensions; Weight ( L x l x h );( kg )	Observations
RS 81953 A-EX	60 W	transparent polycarbonate	6150 lm	1200 x 130 x 89 mm 4,2 kg	-
RS 81953 B-EX	35 W	transparent polycarbonate	3700 lm	732 x 130 x 89 mm 3,5 kg	-

Antiex 

Lighting devices marked with antiex sign are designed for operation in risk of explosion areas (zone 2 protection level Gc gas group IIB, temperature class T4 max.100°, type of protection "nA" and "mc" ) and for risk of explosion due dust lighting, zone 22 with level of protection Dc- group IIIC (maximum surface temperature of 100 °) type of protection tc.

Compliance standards:  
 SR EN 60598-1:2015+AC:2016  
 SR EN 60598-2-5:2016  
 SR EN 55015:2014+A1:2015  
 SR EN 61000-3-2:2015  
 SR EN 61000-3-3:2014  
 SR EN 61547:2010  
 SR EN 60079-0:2013  
 SR EN 60079-15:2011  
 SR EN 60079-31:2014



# GEMMA

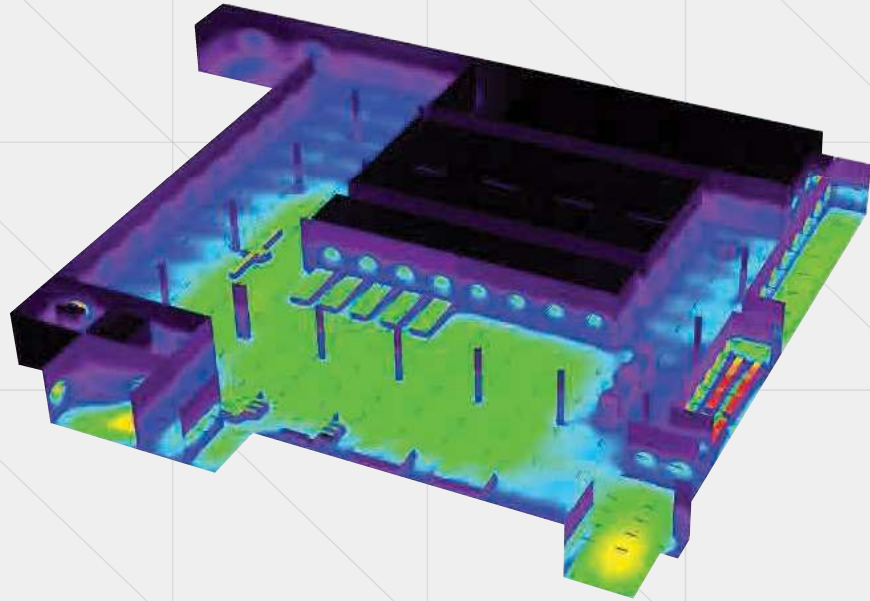
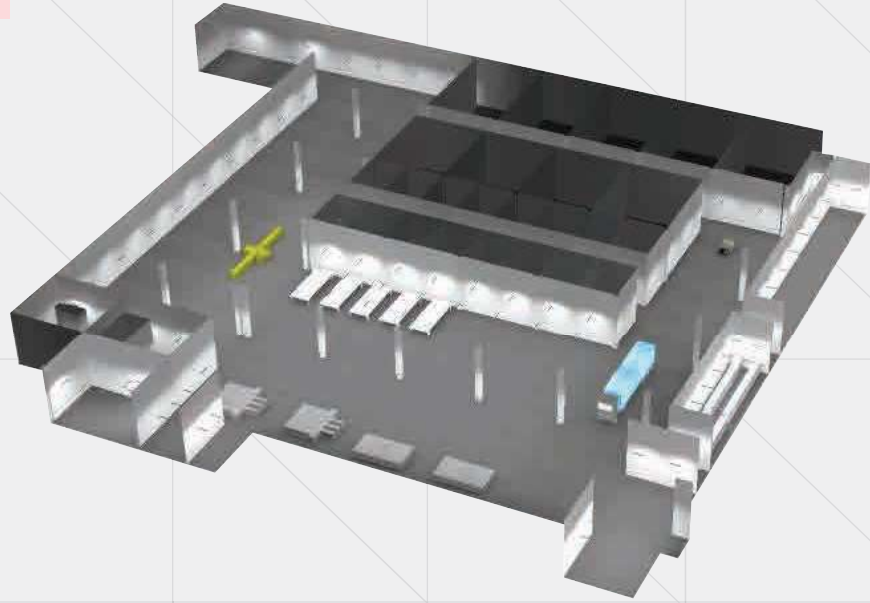

Height of space : 12.000 m  
 Maintenance factor : 0.80

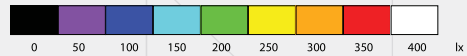

Surface	$\rho$ [%]	$E_m$ [lx]	$E_{min}$ [lx]	$E_{max}$ [lx]	$u_0$
Usable plan	/	105	0.19	364	0.002
Floor	20	99	0.21	288	0.002
Ceiling	70	20	0.24	61	0.012
Walls	50	23	0.41	577	/